

Technical data sheet

Product features



Drop-in electric induction cooker with 12 performance levels

Model	SAP Code	00038647
RIB 35 D	A group of articles - web	Stoves



- Device type: Electric unit
- Power consumption of the zone 1 [kW]: 3,5

SAP Code	00038647	Power electric [kW]	3.500
Net Width [mm]	380	Loading	230 V / 1N - 50 Hz
Net Depth [mm]	360	Number of zones	1
Net Height [mm]	81	Power consumption of the zone 1 [kW]	3,5
Net Weight [kg]	8.50	Ceramic glass dimensions [mm x mm]	360 x 380

Technical data sheet



Technical drawing

Drop-in electric induction cooker with 12 performance levels

Model	SAP Code	00038647
RIB 35 D	A group of articles - web	Stoves

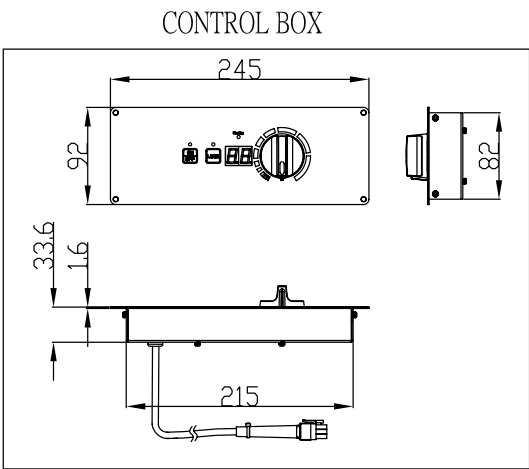
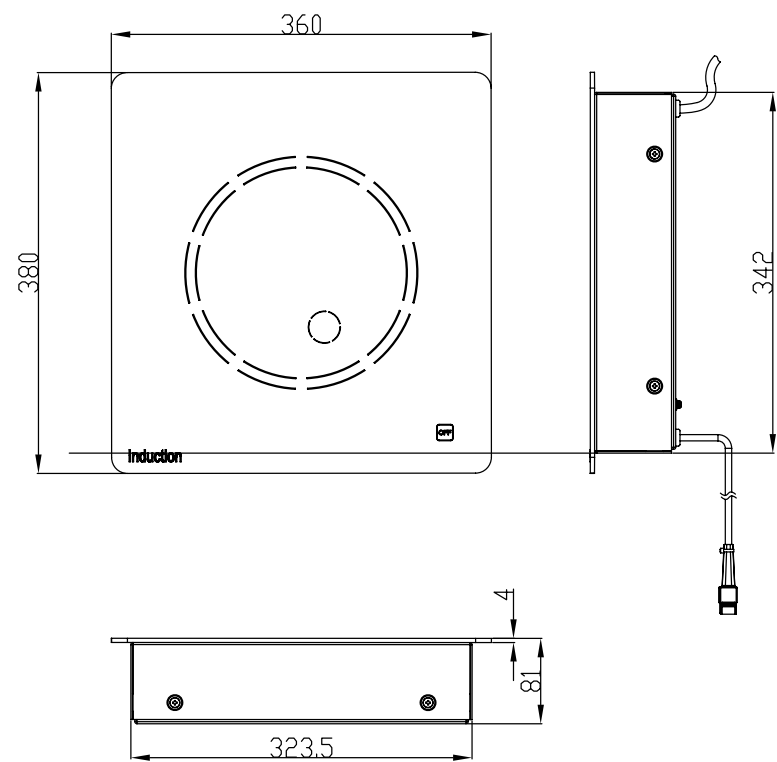

Technical data sheet



Product benefits

Drop-in electric induction cooker with 12 performance levels

Model	SAP Code	00038647
RIB 35 D	A group of articles - web	Stoves

1

12 power levels

Possibility of cooking with different intensities

2

Glass cooking surface

Easy cleaning

3

Drop-in device designed for installation

Enables to maintain the desired appearance of the surrounding interior elements

4

Touch control

Easy operation and touch control

5

Automatic safety switch-off

If the temperature of the bottom of the cookware is too high, the power is turned off.

6

Overcooking time detector

If the pot is left on the induction hob for more than 2 hours or if the user does not use any functions for more than 2 hours, the hob is automatically turned off.

7

Integrated circuit automatic reset device

the main control microprocessor is equipped with a watchdog that automatically resets itself when the software program fails.

8

2-step switch-on

a safety feature governed by legislation

9

For best results, use pots with a diameter of 12 to 26 cm.

high variability of the use of different diameters of pots, pans and saucepans

10

Material compatibility detector

if the induction unit is switched on for more than 60 seconds without a pot or with an incompatible pot, the unit switches off automatically.

11

Small object detector

if the material of the pan or pot or its dimensions are not suitable for the induction unit, the power indicator light will not light up. The induction unit will not recognise any objects or utensils smaller than 5 cm in diameter.

12

Suitable for iron, cast iron, stainless steel, enameled pots and pans with a flat magnetic bottom.

possibility of using cookware made of a wide range of materials for cooking

Technical data sheet

Technical parameters



Drop-in electric induction cooker with 12 performance levels

Model	SAP Code	00038647
RIB 35 D	A group of articles - web	Stoves

1. SAP Code:

00038647

2. Net Width [mm]:

380

3. Net Depth [mm]:

360

4. Net Height [mm]:

81

5. Net Weight [kg]:

8.50

6. Gross Width [mm]:

550

7. Gross depth [mm]:

460

8. Gross Height [mm]:

210

9. Gross Weight [kg]:

10.00

10. Device type:

Electric unit

11. Construction type of device:

Drop-in

12. Power electric [kW]:

3.500

13. Loading:

230 V / 1N - 50 Hz

14. Exterior color of the device:

Stainless steel

15. Indicators:

Digital

16. Worktop material:

Glass ceramics

17. Number of zones:

1

18. Power consumption of the zone 1 [kW]:

3,5

19. Number of power control stages:

12

20. Number of burners/hot plates:

1

21. Type of electric cooking zones:

Induction

22. Ceramic glass dimensions [mm x mm]:

360 x 380

23. Cross-section of conductors CU [mm²]:

1